

# MBES15\_-10,16-V

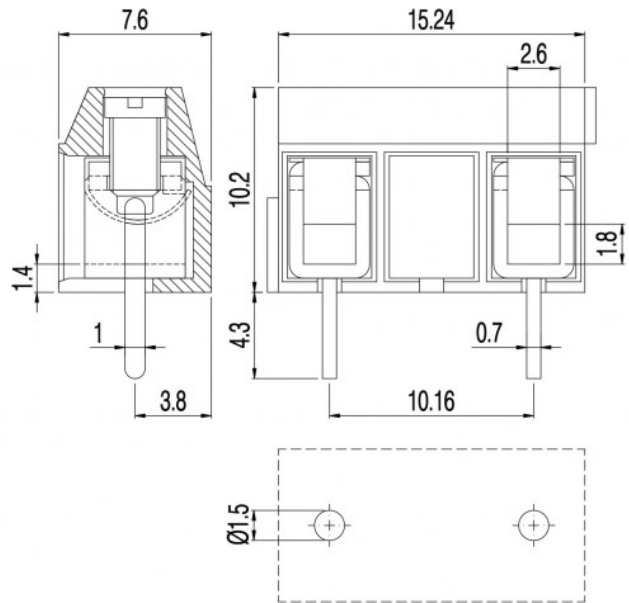

### GENERAL INFORMATION

pitch	10,16 mm
Height	10.2 mm
Depth	7.6 mm
Dimensional class	Bassa
Wire section	2.5 mm <sup>2</sup> / 14 AWG
Clamp opening size	2.6 x 2 mm
Wire stripping	max 7 mm
Operating temperature	-40 ÷ +130 °C

### ELECTRICAL CHARACTERISTICS

Current	24 A
Voltage	1000 V
impulse voltage	3.5 kV

### MECHANICAL CHARACTERISTICS

Screw	M2.5
Recommended torque	0.4÷0.44 Nm / 3.6÷4 in.lbs

### APPROVALS DATA



	EN 60998-1	EN 60998-1	UL 1059
Current	17.5 A	24 A	20 A factory / 15 A field
Voltage	750 V	1000 V	600 V
Wire section	1.5 mm <sup>2</sup>	2.5 mm <sup>2</sup>	14 AWG
Torque	0.4 Nm	0.4 Nm	3.6 Nm
FILE	EP151	40019705	E178356

### MATERIALS

Housing	PA - UL 94 V0
Screw	Galvanized steel
Clamp	Tin-plated copper alloy

Terminal  
SCIP Number

Tin-plated copper alloy  
b32084c4-2e9c-4e90-8741-a93d2ab379fe

**COLOURS**

Standard



On request



**POLES**

**NAME**

**3D FILE**

1	MBES151-10,16-V	File not available for this product
2	MBES152-10,16-V	File not available for this product