

# MVE17\_-7,5-V

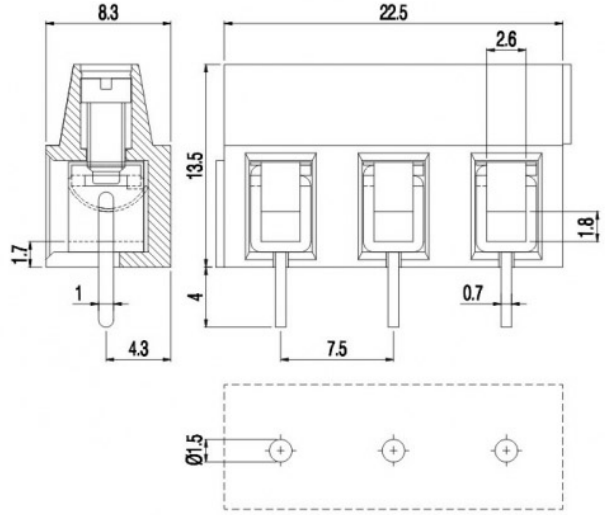
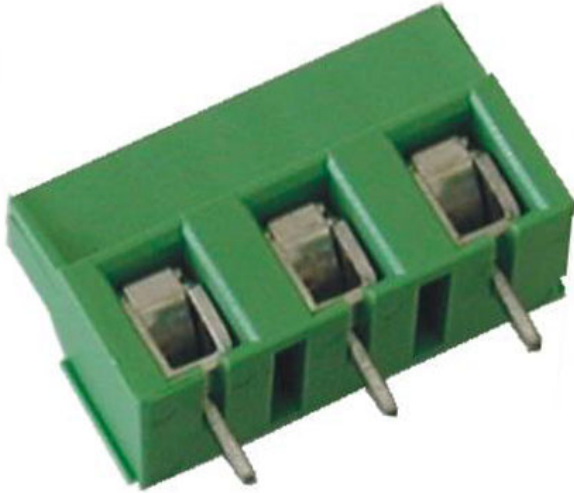

### GENERAL INFORMATION

pitch	7,5 mm
Height	13,5 mm
Depth	8,3 mm
Dimensional class	Bassa
Wire section	1.5 mm <sup>2</sup> / 16 AWG
Clamp opening size	2.6 x 2.6 mm
Wire stripping	max 7 mm
Operating temperature	-40 ÷ +130 °C

### ELECTRICAL CHARACTERISTICS

Current	17.5 A
Voltage	750 V
Test Voltage	3 kVrms/60s

### MECHANICAL CHARACTERISTICS

Screw	M2.5
Recommended torque	0.4÷0.44 Nm / 3.6÷4 in.lbs

### APPROVALS DATA



	<b>EN 60998-1</b>	<b>EN 60998-1</b>	<b>UL 1059</b>
Current	17.5 A	17.5 A	17.5 A factory / 10 A field
Voltage	750 V	750 V	300 V
Wire section	1.5 mm <sup>2</sup>	1.5 mm <sup>2</sup>	16 ÷ 30 AWG
Torque	0.4 Nm	0.4 Nm	3.6 Lb-in
FILE	EP151	40019705	E178356

### MATERIALS

Housing	PA - UL 94 V0
Screw	Galvanized steel
Clamp	Tin-plated copper alloy
Terminal	Tin-plated copper alloy

### COLOURS

Standard  
**GN**

On request

**GY** **BK** **BL** **RD** **YL** **OG**

**POLES**

2  
3

**NAME**

MVE172-7,5-V  
MVE173-7,5-V

**3D FILE**

File available  
File available